

BENCH MARK
 City Bench Mark #44
 SE Corner of Baseline St & "H" St
 Elevation 1119.97 M.S.L.

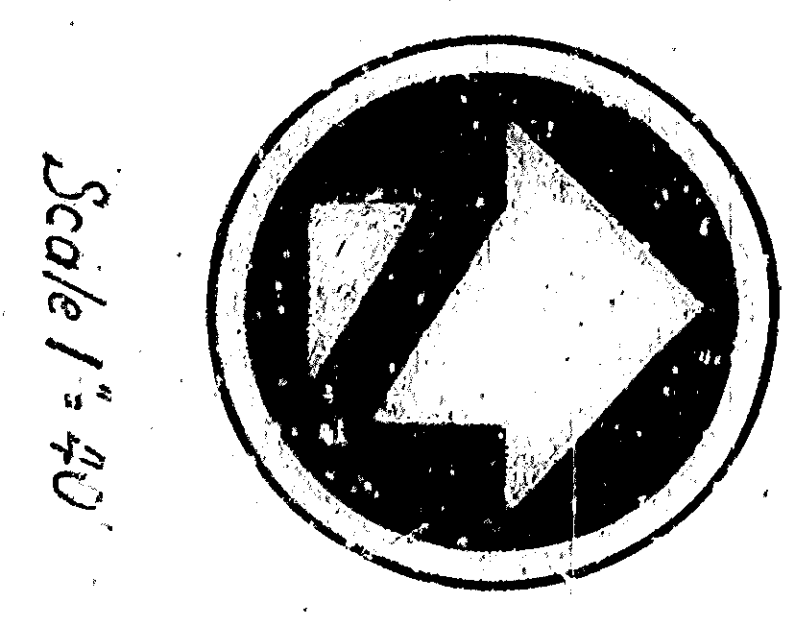

BASE LINE STREET
 Between "H" Street and Waterman Avenue
 Wloering
 R.C.C. & S.E.
 Ronald E. Wloering
 9795
 2766

STREET IMPROVEMENT SHEET 1

GENERAL NOTES

1. All work indicated on these plans shall be done in conformity with applicable provisions of Standard Specifications, State of California, Department of Public Works, Division of Highways, dated _____.
2. Street name signs and standards shall be removed and replaced as directed by the Engineer, before shall be clean & correct same as original installation.
3. Removal of Obstructions:

 1. To be removed under this contract.
 2. To be removed and replaced under this contract.
 3. To be removed or altered by others.

4. Pavement to be constructed shown this _____.
5. Bench Mark #44
 City Bench Mark #44 at SE Corner of Baseline Street and "H" Street.
6. For details of Cost, Schedules, Standards and Drawings see City of San Bernardino Dept. of Engineering, Drawing No. 524.
7. Sidewalks, curbs and other construction shall be installed in places shown, with an existing sidewalk will be replaced by the Engineer.
8. The contractor shall maintain construction of the street and paved with the work in an orderly condition.

11/6/98

Widening of Baseline St. From N. St. to H. St.

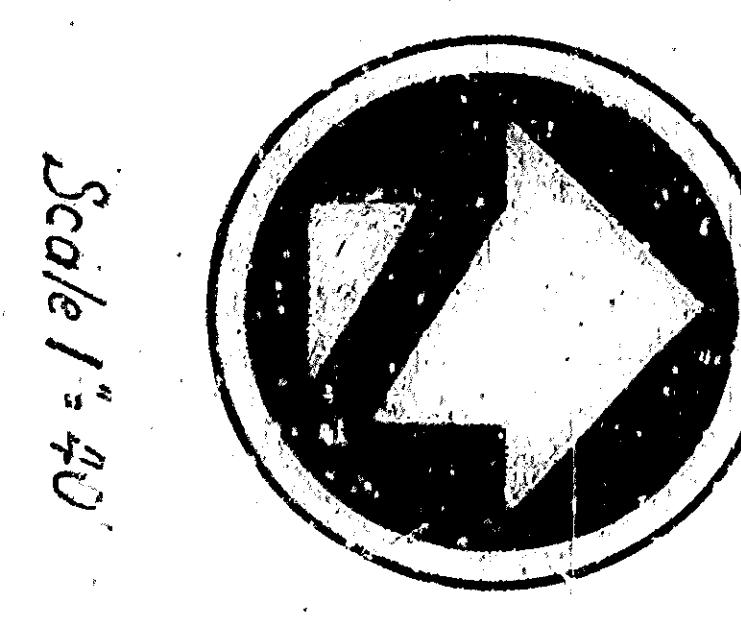



Scale: 1" = 40'

BASE LINE STREET
Between H Street and Waterman Avenue
Wloering
R.C. Rife
April 24, 1998
Ronald E. Wloering
9795
MD
2766

STREET IMPROVEMENT SHEET 1

GENERAL NOTES

- All work shall be done in conformity with applicable provisions of Standard Specifications, State of California, Department of Public Works, Division of Highways, dated.
- Street name signs and standards shall be removed and replaced as directed by the Engineer, before shall be clean & correct same as original installation.
- Remove all Obstructions.
- It is removed under this contract.
- It is removed and replaced under this contract.
- It is removed or altered by others.
- Payment is to contractor shown this.
- Check Mark.
- City Bench Mark No. 44, S.E. Corner of Baseline Street and H Street.
- For details of Cost, Schedules, Standards and Drawings see City of San Bernardino Dept. of Engineering, Drawing No. 524.
- Subcontractor shall be responsible for all work shown on this sheet and as directed by the Engineer.
- The contractor shall maintain construction of the street and paved with the work on an hourly basis.




- GENERAL NOTES**
- All work indicated on these plans shall be done in conformity with applicable provisions of Standard Specifications, State of California, Department of Public Works, Division of Highways, dated 1997.
 - Street name signs and standards shall be removed and replaced as directed by the Engineer, before the clean & construct same as original installation.
 - Remove all Obstructions.
 - It is removed under this contract.
 - It is removed and replaced under this contract.
 - It is removed or altered by others.
 - Payment is to contractor shown this:
 1. City Bench Mark #44
 2. S.E. Corner of Baseline St. E.T. 119.97, 10.51
 3. S.E. Corner of Baseline St. E.T. 119.97, 10.51
 4. S.E. Corner of Baseline St. E.T. 119.97, 10.51
 5. S.E. Corner of Baseline St. E.T. 119.97, 10.51
 6. S.E. Corner of Baseline St. E.T. 119.97, 10.51
 7. S.E. Corner of Baseline St. E.T. 119.97, 10.51
 8. S.E. Corner of Baseline St. E.T. 119.97, 10.51
 9. S.E. Corner of Baseline St. E.T. 119.97, 10.51
 10. S.E. Corner of Baseline St. E.T. 119.97, 10.51
 11. S.E. Corner of Baseline St. E.T. 119.97, 10.51
 12. S.E. Corner of Baseline St. E.T. 119.97, 10.51
 13. S.E. Corner of Baseline St. E.T. 119.97, 10.51
 14. S.E. Corner of Baseline St. E.T. 119.97, 10.51
 15. S.E. Corner of Baseline St. E.T. 119.97, 10.51
 16. S.E. Corner of Baseline St. E.T. 119.97, 10.51
 17. S.E. Corner of Baseline St. E.T. 119.97, 10.51
 18. S.E. Corner of Baseline St. E.T. 119.97, 10.51
 19. S.E. Corner of Baseline St. E.T. 119.97, 10.51
 20. S.E. Corner of Baseline St. E.T. 119.97, 10.51
 21. S.E. Corner of Baseline St. E.T. 119.97, 10.51
 22. S.E. Corner of Baseline St. E.T. 119.97, 10.51
 23. S.E. Corner of Baseline St. E.T. 119.97, 10.51
 24. S.E. Corner of Baseline St. E.T. 119.97, 10.51
 25. S.E. Corner of Baseline St. E.T. 119.97, 10.51
 26. S.E. Corner of Baseline St. E.T. 119.97, 10.51
 27. S.E. Corner of Baseline St. E.T. 119.97, 10.51
 28. S.E. Corner of Baseline St. E.T. 119.97, 10.51
 29. S.E. Corner of Baseline St. E.T. 119.97, 10.51
 30. S.E. Corner of Baseline St. E.T. 119.97, 10.51
 31. S.E. Corner of Baseline St. E.T. 119.97, 10.51
 32. S.E. Corner of Baseline St. E.T. 119.97, 10.51
 33. S.E. Corner of Baseline St. E.T. 119.97, 10.51
 34. S.E. Corner of Baseline St. E.T. 119.97, 10.51
 35. S.E. Corner of Baseline St. E.T. 119.97, 10.51
 36. S.E. Corner of Baseline St. E.T. 119.97, 10.51
 37. S.E. Corner of Baseline St. E.T. 119.97, 10.51
 38. S.E. Corner of Baseline St. E.T. 119.97, 10.51
 39. S.E. Corner of Baseline St. E.T. 119.97, 10.51
 40. S.E. Corner of Baseline St. E.T. 119.97, 10.51
 41. S.E. Corner of Baseline St. E.T. 119.97, 10.51
 42. S.E. Corner of Baseline St. E.T. 119.97, 10.51
 43. S.E. Corner of Baseline St. E.T. 119.97, 10.51
 44. S.E. Corner of Baseline St. E.T. 119.97, 10.51
 45. S.E. Corner of Baseline St. E.T. 119.97, 10.51
 46. S.E. Corner of Baseline St. E.T. 119.97, 10.51
 47. S.E. Corner of Baseline St. E.T. 119.97, 10.51
 48. S.E. Corner of Baseline St. E.T. 119.97, 10.51
 49. S.E. Corner of Baseline St. E.T. 119.97, 10.51
 50. S.E. Corner of Baseline St. E.T. 119.97, 10.51
 51. S.E. Corner of Baseline St. E.T. 119.97, 10.51
 52. S.E. Corner of Baseline St. E.T. 119.97, 10.51
 53. S.E. Corner of Baseline St. E.T. 119.97, 10.51
 54. S.E. Corner of Baseline St. E.T. 119.97, 10.51
 55. S.E. Corner of Baseline St. E.T. 119.97, 10.51
 56. S.E. Corner of Baseline St. E.T. 119.97, 10.51
 57. S.E. Corner of Baseline St. E.T. 119.97, 10.51
 58. S.E. Corner of Baseline St. E.T. 119.97, 10.51
 59. S.E. Corner of Baseline St. E.T. 119.97, 10.51
 60. S.E. Corner of Baseline St. E.T. 119.97, 10.51
 61. S.E. Corner of Baseline St. E.T. 119.97, 10.51
 62. S.E. Corner of Baseline St. E.T. 119.97, 10.51
 63. S.E. Corner of Baseline St. E.T. 119.97, 10.51
 64. S.E. Corner of Baseline St. E.T. 119.97, 10.51
 65. S.E. Corner of Baseline St. E.T. 119.97, 10.51
 66. S.E. Corner of Baseline St. E.T. 119.97, 10.51
 67. S.E. Corner of Baseline St. E.T. 119.97, 10.51
 68. S.E. Corner of Baseline St. E.T. 119.97, 10.51
 69. S.E. Corner of Baseline St. E.T. 119.97, 10.51
 70. S.E. Corner of Baseline St. E.T. 119.97, 10.51
 71. S.E. Corner of Baseline St. E.T. 119.97, 10.51
 72. S.E. Corner of Baseline St. E.T. 119.97, 10.51
 73. S.E. Corner of Baseline St. E.T. 119.97, 10.51
 74. S.E. Corner of Baseline St. E.T. 119.97, 10.51
 75. S.E. Corner of Baseline St. E.T. 119.97, 10.51
 76. S.E. Corner of Baseline St. E.T. 119.97, 10.51
 77. S.E. Corner of Baseline St. E.T. 119.97, 10.51
 78. S.E. Corner of Baseline St. E.T. 119.97, 10.51
 79. S.E. Corner of Baseline St. E.T. 119.97, 10.51
 80. S.E. Corner of Baseline St. E.T. 119.97, 10.51
 81. S.E. Corner of Baseline St. E.T. 119.97, 10.51
 82. S.E. Corner of Baseline St. E.T. 119.97, 10.51
 83. S.E. Corner of Baseline St. E.T. 119.97, 10.51
 84. S.E. Corner of Baseline St. E.T. 119.97, 10.51
 85. S.E. Corner of Baseline St. E.T. 119.97, 10.51
 86. S.E. Corner of Baseline St. E.T. 119.97, 10.51
 87. S.E. Corner of Baseline St. E.T. 119.97, 10.51
 88. S.E. Corner of Baseline St. E.T. 119.97, 10.51
 89. S.E. Corner of Baseline St. E.T. 119.97, 10.51
 90. S.E. Corner of Baseline St. E.T. 119.97, 10.51
 91. S.E. Corner of Baseline St. E.T. 119.97, 10.51
 92. S.E. Corner of Baseline St. E.T. 119.97, 10.51
 93. S.E. Corner of Baseline St. E.T. 119.97, 10.51
 94. S.E. Corner of Baseline St. E.T. 119.97, 10.51
 95. S.E. Corner of Baseline St. E.T. 119.97, 10.51
 96. S.E. Corner of Baseline St. E.T. 119.97, 10.51
 97. S.E. Corner of Baseline St. E.T. 119.97, 10.51
 98. S.E. Corner of Baseline St. E.T. 119.97, 10.51
 99. S.E. Corner of Baseline St. E.T. 119.97, 10.51
 100. S.E. Corner of Baseline St. E.T. 119.97, 10.51

BASE LINE STREET
Between H Street and Waterman Avenue
Widening
R.C. 7-4-4
April 24, 2008
Ronald E. Weygand
9795
2766
1

STREET IMPROVEMENT SHEET 1